

NO.	DELTA	RADIUS	ARC	TANGENT	C-BEARING	CHORD
1	0°14'21"	2902.29'	12.11'	6.05'	N82°55'10"E	12.11'
2	0°17'46"	2902.29'	15.00'	7.50'	N82°39'06"E	15.00'
3	0°06'42"	2902.29'	5.66'	2.83'	N02°26'52"E	5.66'
4	3°03'04"	2902.29'	154.56'	77.30'	N00°51'59"E	154.54'

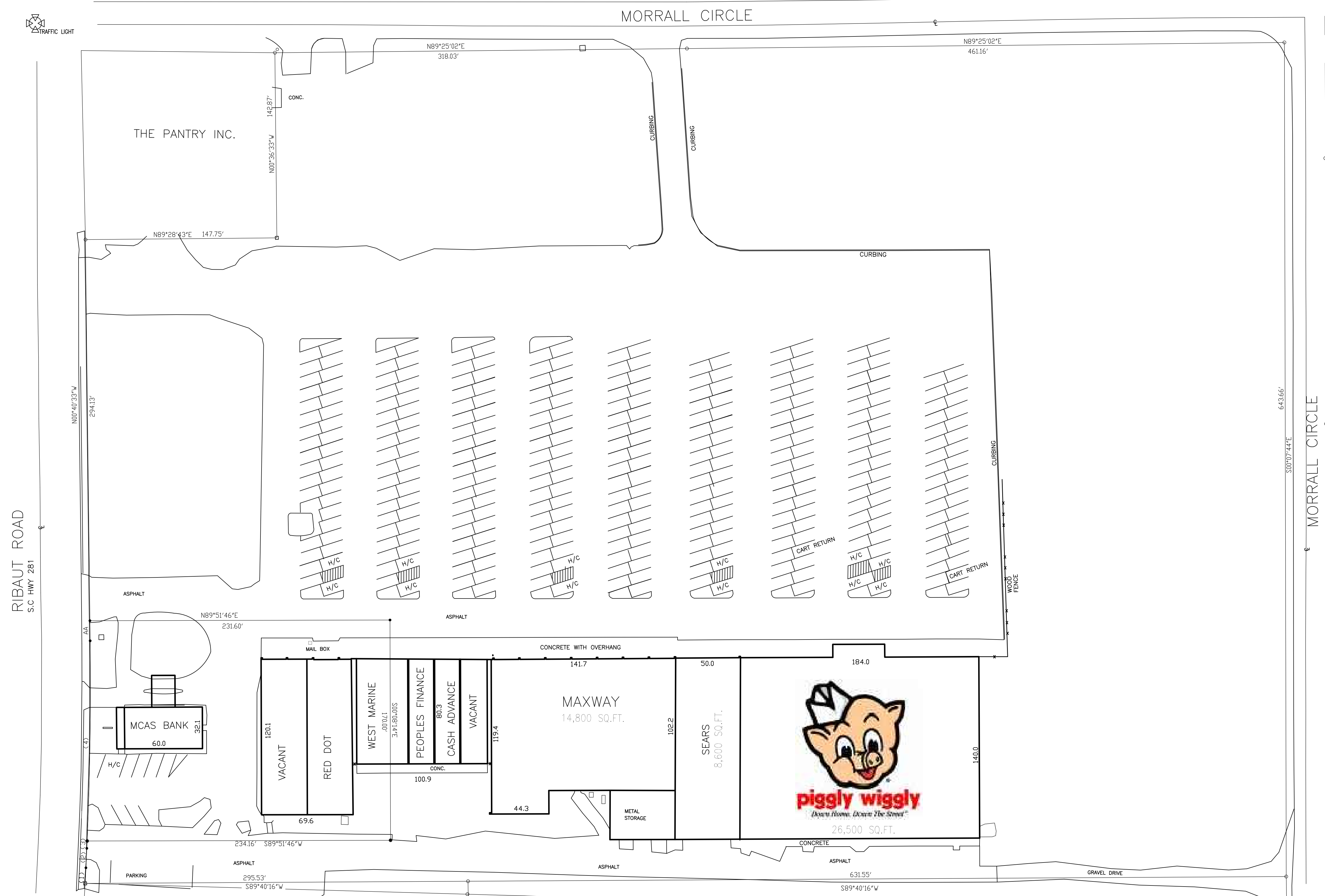

Site Plan
SCALE: 1"=40'-0"



NOT AN OFFICIAL DOCUMENT UNLESS SIGNED

Royal Oaks

Port Royal, SC

ISSUE DATES

10/5/2010

Project No.
2129.3

C100